

HIGH LOW THERMOSTATIC MIXING VALVES

XL-690-LF-DT _____ 1-65 GPM (3.8-246 l/min)

ECO-MIX™

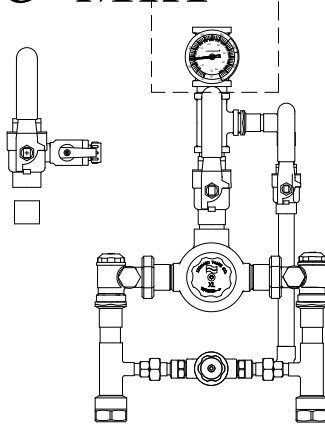

DT ASSEMBLY
IS A COMPONENT ACCESSORY
INCLUDED BY FACTORY

- High Low Thermostatic Water Mixing Valve with 0.5 GPM (1.9 l/min) minimum flow capacity, 1 GPM (3.8 l/min) to ASSE 1069
- 1" inlets, 1-1/4" outlet (25mm x 32 mm)
- Dial Thermometer on outlet
- Test Connection (ship loose)
- Integral combination check-stops with strainers and wall support
- 125 PSI (8.6 BAR) maximum operating pressure with temperature control down to 0.5 GPM (1.9 l/min)
- Copper encapsulated thermostatic element assemblies with Teflon coated shuttle
- Locking temperature regulating handle set for 120°F(49°C)*
- Temperature adjustment range, 90-140°F (32-60°C) **
- Internal parts of stainless steel
- Rough bronze finish

PRESSURE DROP													
MIN FLOW	5	10	15	20	25	30	35	40	45	50	55	60	PSI
	0.3	0.7	1	1.4	1.7	2.1	2.4	2.8	3.1	3.4	3.8	4.1	BAR
1	5	10	20	35	39	41	48	55	59	62	64	65	GPM
3.8	19	38	76	132	148	155	182	208	223	235	242	246	l/min

NOTE: Flowrates will vary depending on existing field conditions. Leonard Valve Company always recommends using CASPAK® sizing software for proper valve sizing and model number applications.

ASSE 1017 Certified
ASSE 1069 Certified



WARNING: This product can expose you to chemicals including lead, which is known to the State of California to cause cancer. For more information, go to www.P65Warnings.Ca.gov

FLOW RATE

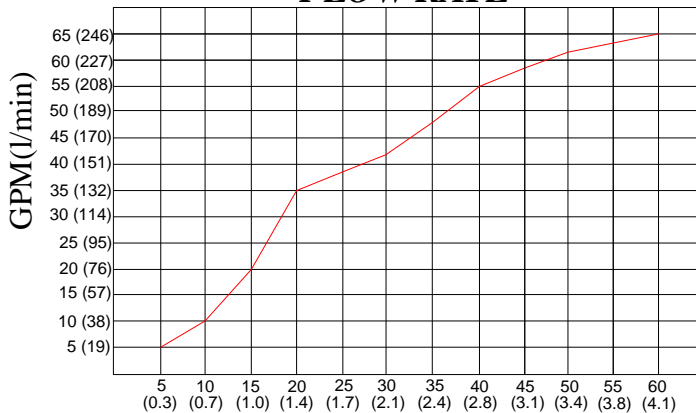

PRESSURE DROP
PSI(BAR)

OPTIONS

___ SUFFIX **IT** Inlet thermometers

NOTE: Leonard Valve Company reserves the right of product or design modification without notice or obligation

This valve is certified to meet Low Lead requirements of wetted surface area containing less than 0.25% lead by weight. All other component accessories, the sum total of which comprise the wetted surface of this product, contain less than one quarter of one percent lead by weight.

*NOTE: A locking temperature regulator set for 120°F (49°C), is simply a mechanical setting to prevent unauthorized temperature set point changes. If incoming water is hotter than 150°F (65.5°C), the temperature of the factory test, the valve may deliver in excess of 120°F. **MUST BE RESET BY THE INSTALLER**

**NOTE: For temperatures outside of this valve's stated range, please see our line of bi-metal valves.

Engineer's Approval _____

Job # _____

Arch/Eng. _____

Contractor _____

Note: The model shown represents Leonard Products which are believed to be equivalent in type and function to items specified. Leonard Valve Company is not responsible for errors or omissions due to differences in interpretations of information provided.

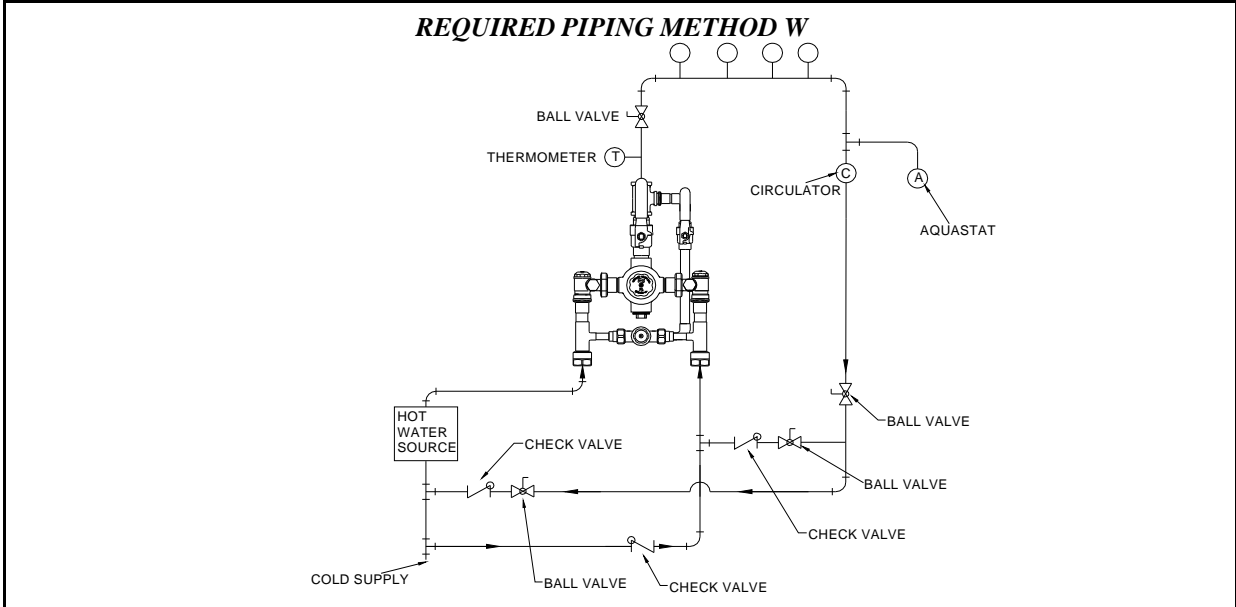
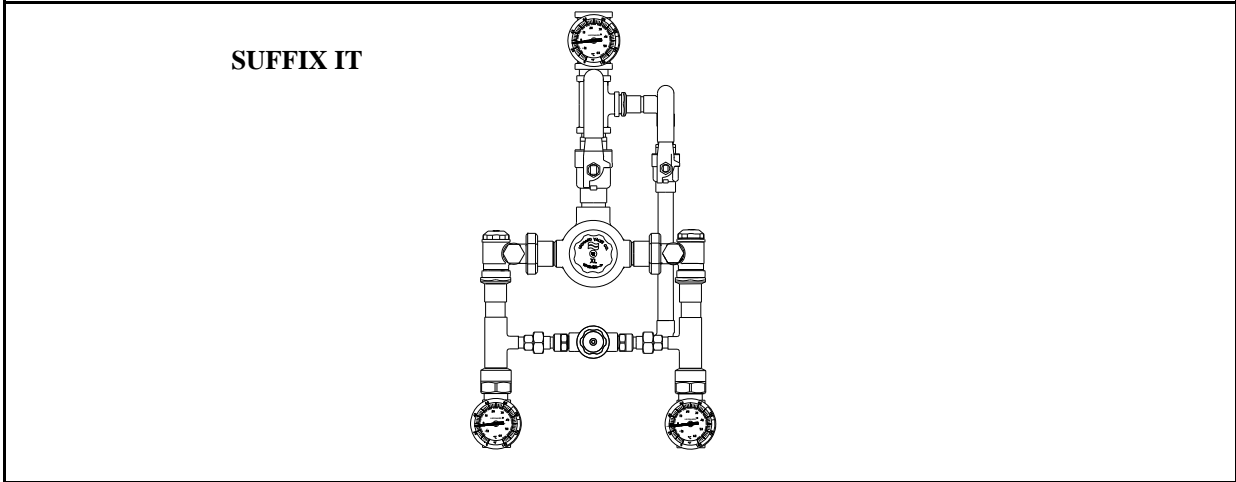
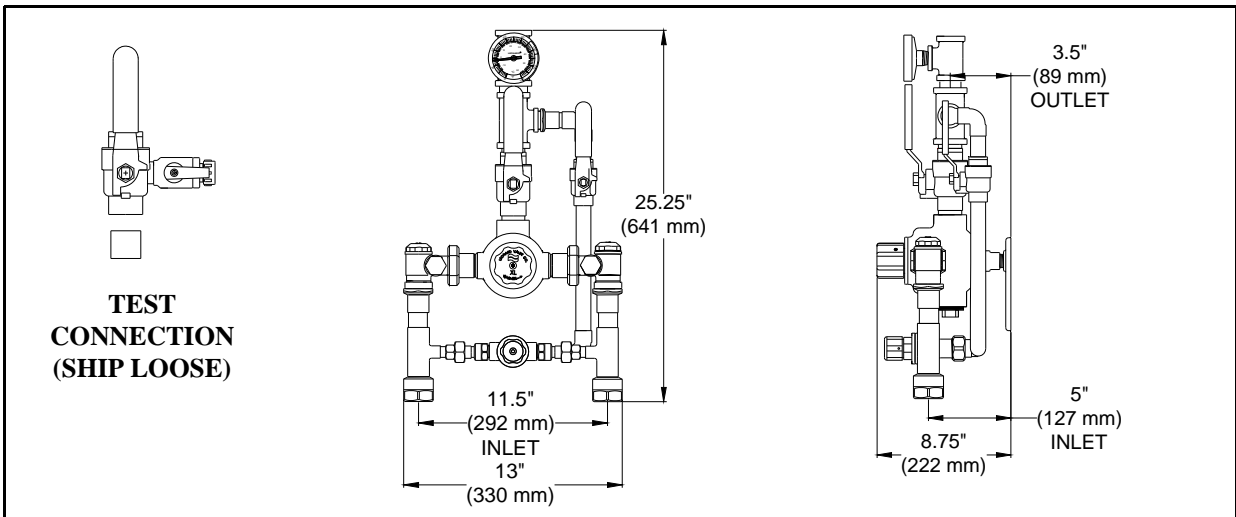

CAUTION! All thermostatic water mixing valves have limitations. They will NOT provide the desired accuracy outside of their flow capacity range. Consult the Flow Capacity Chart and DO NOT OVERSIZE. Minimum flow must be no less than as indicated.



1360 Elmwood Avenue, Cranston, RI 02910 USA
 Phone: 401.461.1200 Fax: 401.941.5310
 Email: info@leonardvalve.com
 Web Site: <http://www.leonardvalve.com>